

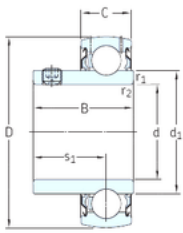

Shanghai Ruonan-Power Co., Ltd.

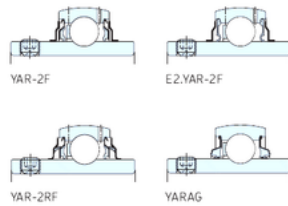

YAT



60 mm x 110 mm x 65,1 mm SKF YAR212-2F deep groove ball bearings

Bearing No. YAR212-2F

Size	60x110x65.1 mm
Bore Diameter	60 mm
Outer Diameter	110 mm
Width	65,1 mm
d	60 mm
D	110 mm
B	65,1 mm
C	26 mm
d1	75,6 mm
r1 min.	1,5 mm
r2 min.	1,5 mm
s1	39,7 mm
Weight	1,35 Kg
Basic dynamic load rating (C)	52,7 kN
Basic static load rating (C0)	36 kN
Fatigue load limit (Pu)	1,53

YAR212-2F Bearing 2D drawings and 3D CAD models